

Pressure Medium Basınç Ortamı	N ₂	Area of Sealing Rod or Position Piston veya Mildeki Sızdırmazlık Alanı	2,01 cm ²
Working Temp. Çalışma Sıcaklığı	0-80°C	Force Increase By Temperature Sıcaklık Etkisiyle Kuvvet Artışı	±0,33%/°C
Min.Filling Pressure Minimum Dolum Basıncı	20 bar	Recommended Max Stroke/Min Tavsiye Edilen Max. Strok/Dk	~20-100 (20°C)
Max Filling Pressure Maximum Dolum Basıncı	150 bar	Max Working Speed Max Çalışma Hızı	1,8 m/s

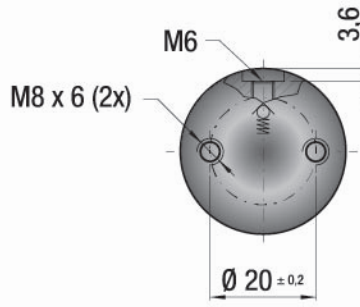
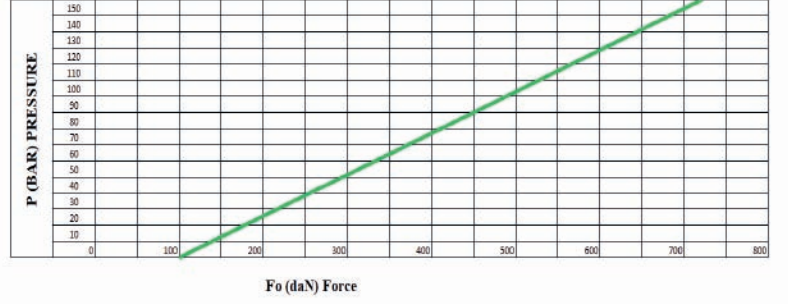
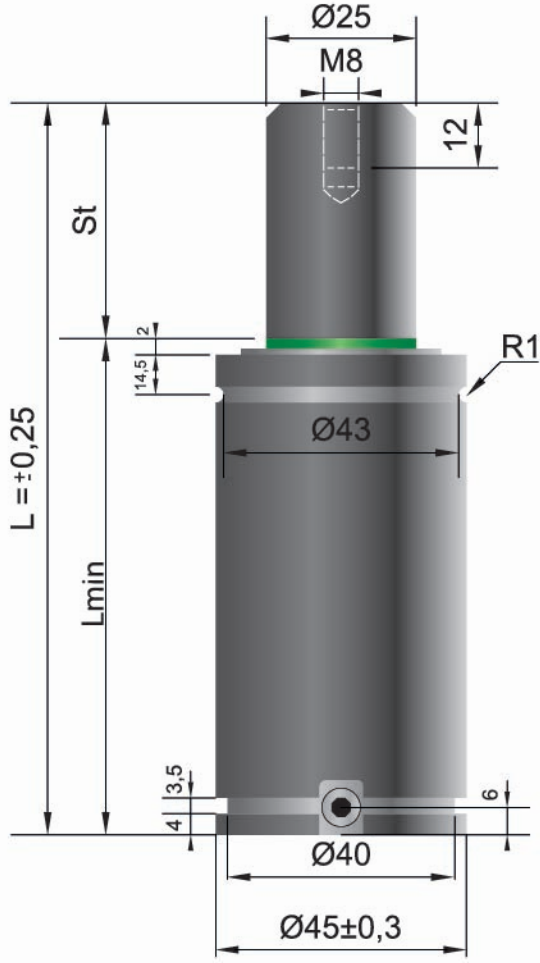

F _{1P}	Polytropic End Force Değişken Sic. Kuvvet
V ₀	Initial Gas Volume Başlangıç Hacmi
F ₀	Initial Force Başlangıç Kuvveti
F _{1I}	Isothermal End Force Sabit Sic. Kuvvet

KOD(CODE)	St (mm)	L (mm)	Lmin (mm)	F ₀ ±%5 (daN)	F _{1I} (daN)	F _{1P} (daN)	V ₀ (cm ³)	 (Kg)
MF 00750 010	10	52	42	+20°C 740 150 bar	1180	1378	15.0	0.41
MF 00750 013	13	58	45		1240	1471	18.0	0.43
MF 00750 016	16	64	48		1255	1495	21,8	0.44
MF 00750 019	19	70	51		1284	1540	25.0	0.46
MF 00750 025	25	82	57		1309	1581	32.0	0.50
MF 00750 032	32	96	64		1360	1663	39.0	0.55
MF 00750 038	38	108	70		1367	1675	46.0	0.58
MF 00750 050	50	132	82		1417	1757	58.0	0.67
MF 00750 063	63	158	95		1436	1788	72.0	0.75
MF 00750 075	75	182	107		1455	1819	84.5	0.83
MF 00750 080	80	192	112		1458	1823	90.0	0.86
MF 00750 100	100	232	132		1466	1837	111.8	0.99
MF 00750 125	125	282	157		1473	1848	139.0	1,15

Teknik bilgiler için
37,38,39
sayfalarına bakınız.

SİPARİŞ KODU
(ORDER CODE)

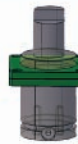

MK
MK45



MQ
MQ45



MKC
MKC45